

oursson®



bon appétit

Instruction manual



Blender BL0640G



Congratulation on buying OURSSON Blender!

SAFETY INSTRUCTIONS



Danger symbol

A reminder to user about high voltage.



Warning symbol

A reminder to user about the necessity of operating exactly according to the instructions.

When using electrical appliances should take the following precautions:

- Use the device according to the following instructions manual.
- Install the device on a stable surface.
- Use only the tools, which are included in the product set.
- To protect against risk of electrical shock do not put the cord in water or other liquid. If for some reason the water got into the unit, contact an authorized service center (ASC) OURSSON AG.
- For power supply, use a power grid with proper characteristics.
- Do not use the device in areas where the air can contain vapors of flammable substances.
- Never attempt to open the device by yourself – it could possibly be the reason of an electrical shock can lead to product malfunction and will invalidate the manufacturer's warranty. For repair and maintenance, contact only authorized service centers meant for repair of products under the trademark OURSSON.
- When moved from a cool to a warm place and vice versa unpack it before use and wait 1-2 hours without turning it on.
- In order to prevent electrical shock do not immerse the entire product or the wires into the water.
- Be particularly careful and cautious when using the device near children.
- Do not touch any moving parts, as this may cause injury.
- The power cord is specially made relatively short in order to avoid the risk of injury.
- Do not allow the cord to hang over the sharp edge of the table or touch hot surfaces.
- Do not connect this device to a grid which is overloaded with other appliances: it can lead to the fact that the device will not function properly.
- Do not install the device near gas and electric stoves and ovens.

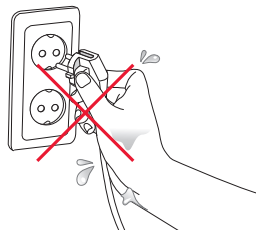
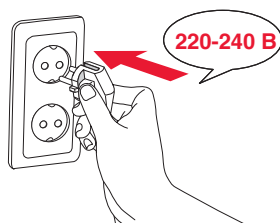

- After use, make sure to disconnect the device from the power grid.
- Keep the device from bumps, falls, vibration and other mechanical influences.
- Make sure to disconnect the device from the power grid before cleaning or changing accessories.
- Do not use the device outdoors.
- This appliance is not intended for use by persons (including children) with reduced physical, sensory or mental capabilities, or lack of experience and knowledge.
- They can only use the device under the supervision of the person responsible for their safety, or after instruction on the safe use of the device. Do not allow children to play with the product.
- Use the product for its intended purpose.
- This product is intended only for use in the home.
- If the power cord is damaged, it must be replaced by a specialist from the authorized service center (ASC) OURSSON AG to avoid danger.
- To avoid burns, do not touch the hot parts of the device with bare hands for as long as they are completely cooled.
- Use only the tools, which are included in the product set.
- When cleaning the appliance do not use abrasives and organic cleaners (alcohol, gasoline, etc.).
- When cleaning the device it is allowed to use a small amount of neutral detergent.
- To avoid burns protect face and hands from steam.
- Do not place the device on non-heat resistant surfaces, such as linoleum, vinyl or paper tablecloths. It may cause fire or damage these surfaces.
- The device must not be installed into the cabinet when operating.
- To avoid injuries or damage of the device, do not hold hands or any other object near blender's blades when the device is working.
- Do not grind very hard ingredients to avoid blunting of the blades.
- To avoid injuries, before installing the blades, place the blender's jar on a clean flat surface.
- Do not start cooking without making sure that the lid is closed correctly and firmly.

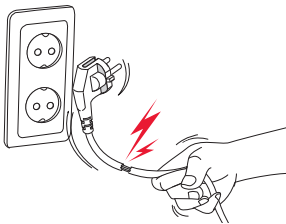

RECOMMENDATIONS

- Please read the instruction manual before using the device. Keep the manual after reading for further use.
- All illustrations in this manual are schematic representations of real objects, which may differ from the actual images.

OPERATION

Before utilizing the device, thoroughly clean all parts, which contact with food.

NOTE! The blades are very sharp, be careful.

Before assembling, make sure that the device is unplugged.

Maximum time of continues use of the blender is 2 minutes, after that you need to turn off the device for 3 minutes.

NOTE! Do not apply physical force to the device, as this may damage the device due to the user's fault.

NOTE! Before turning on the device, make sure that the rotary switch is in  position.

PRODUCT SET



Measuring cup.....	1 pc.
Lid.....	1 pc.
Blender's jar.....	1 pc.
Chopper.....	1 pc.
Blades.....	1 pc.
Coupling	1 pc.
Motor unit	1 pc.
Instruction manual	1 pc.
Recipe book	1 pc.
Warranty card	1 pc.

ELEMENTS OF DESIGN

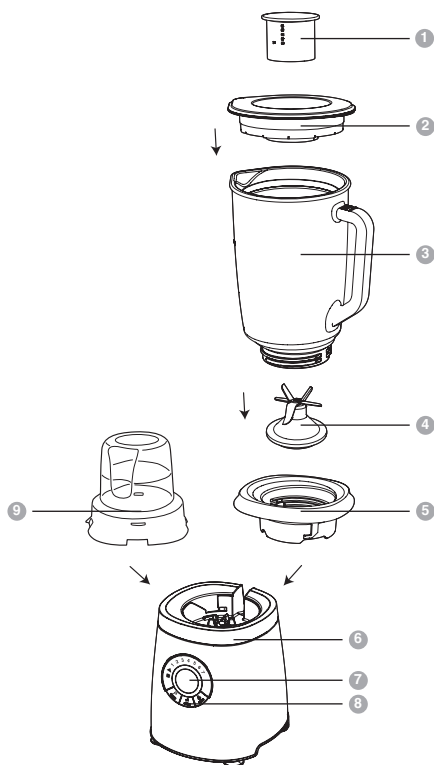
- ① Measuring cup
- ② Lid
- ③ Blender's jar
- ④ Blades
- ⑤ Coupling
- ⑥ Motor unit
- ⑦ Rotary switch with buttons
 - Smoothie
 - Ice crushing
 - Fast mix and easy cleaning
- ⑧ Power indicator
- ⑨ Chopper



UTILIZING THE JAR

1. Place the jar onto the motor unit.
2. Plug in the device.
3. Select the required speed, using the speed button. Blender has a smooth speed regulator (from high to low). The Mix/Grid process will start automatically.
4. You may also turn on the blender by holding the fast mix button **P**. In this case, the device will be working at max speed all the time. The speed won't change even if you will change the switch's position. To turn off the device, release the button.
5. To prepare smoothie press  button. To stop, press the button again.
6. For ice crushing, press  button. To stop, press it again.

TIP! To get ice crumb, select the maximum speed level, or hold «P» button for a few seconds. If the pieces are still big, repeat the operation.

7. To finish working with blender, turn the switch to  position. Unplug the device.
8. After that you can disassemble the device. You can open the lid only when the jar is removed.

UTILIZING THE CHOPPER

1. The chopper is design to grind coffee beans, rice, wheat, peeled nuts, pepper, sesame seeds, dried beans, hard cheese, and breadcrumbs.

TIP! Always grind cloves, star anise and aniseed together with other ingredients.

NOTE! The chopper is not designed to grind very hard ingredients like nutmeg or ice cubes. Do not fill the chopper's cup higher than the max mark.

2. Open the chopper and put necessary ingredients. Close the jar.
3. Place the chopper onto the electric motor as shown on the picture.
4. Plug in the device.
5. Turn on the blender, hold the fast mix button **P**.
To turn of the device relies the button.

After utilizing the blender, clean the device as written on the 11 page.





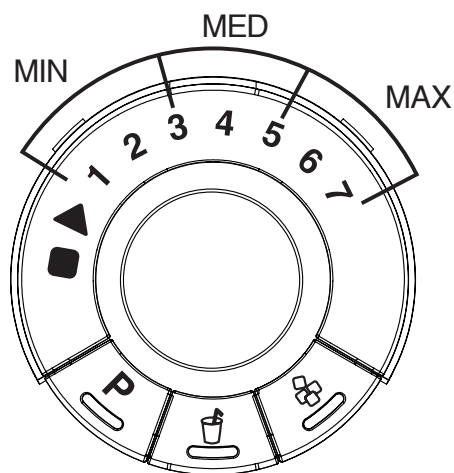



SPEED REGULATION

The device is equipped with a smooth speed regulator. You can change the speed with the help of speed regulator from 1 to 7 clockwise and counterclockwise, where 1 is minimal speed and 7 maximal.



GRINDING RECOMMENDATIONS



Before grinding, it is recommended to chop ingredients on 2x2x2 cm pieces. Max amount of ingredients is shown in the table. Follow the recommendations in the recipe book.

Operation					Note
Smoothies and milkshakes	1500 ml	—		60 sec.	To turn of the device press  button again.
Puree from fresh fruit, berries and vegetables	1500 ml	—	MAX (5-7)	30-45 sec.	The ingredients must be soft or juicy (bananas, strawberries, cucumbers, etc.)
Puree from cooked fruits, vegetables and soups	750 ml	—	MAX(5-7)	30-45 sec.	Do not puree ingredients with a temperature higher than 90 oC
Kneading dough for pancakes, omelets, etc.	1250 ml	—	MED (3-5)	30 - 45 sec.	Suitable for every liquid dough
Preparing sauces and salad dressings with the addition of fresh herbs and garlic	1500 ml	—	MAX (5-7)	30-45 sec.	It is recommended to pass garlic through the press, herbs must be cut.
Preparing snacks like pates, pastes, mousses, vegetable and mushroom caviar, spreads, etc.	750 ml	—	MIN (1 -3)/ MED(3-5)/ MAX(5-7)	90-120 sec.	Cut dense ingredients into pieces (boiled meat, fried liver, etc.).
Preparation of mince from meat / fish / poultry	750 ml	—	MIN (1 -3)/ MED(3-5)/ MAX(5-7)	90-120 sec.	It is recommended to add more liquid into the mince (water, milk, cream) compared to the preparation of traditional mince. Ideal for cooking dumplings, liver fritters).
Preparation of fruit / berry / mousse and sorbet	750 g	—	MIN (1 -3)/ MED(3-5)/ MAX(5-7)	60 sec.	Frozen fruits and berries should thaw a bit, so they can be cut with a knife.
Ice crushing	10-15 cubes	—		15 sec.	To turn of the device press  button again

Preparation of mayonnaise	750 ml	—	MAX (5-7)/ MED(3-5)	90-120 sec.	It is recommended to install in place of the measuring cup a plastic one with a small hole at the bottom, so that the oil came into the bowl of a blender in a thin stream and mix better with the egg mixture.
Preparation of creams and desserts	750 ml	—	MIN (1 -3)/ MED(3-5)/ MAX(5-7)	60 sec.	Use chilled high fat cream, softened butter, room temperature custard, pass curd through a sieve.
Grinding garlic (onion)	100-200 g	—	P	20 sec.	Use impulse mode, press and hold P for 2 sec.(10-15 times).
Grinding nuts	—	25-75 g	P	30 sec.	Nuts must be cleaned of shell and solid walls. Suitable for grinding: almonds, peanuts, hazelnuts, cashews, sesame seeds, coconut pulp, pine nuts and walnuts. When filling a chopping cup ingredients must not exceed the max mark. Press and hold P button.
Grinding beans, cereals and grains	—	25-75 g	P	30 sec.	Clean the rump of impurities in order to avoid damage of the blender blades. Suitable for grinding: beans, buckwheat, corn, oats, barley, wheat cereals, etc. After grinding, the flour should be sifted through a small sieve. Flour of cereals and grasses is used for baking breads, pancakes and pastry products with reduced calorie. Press and hold P button.
Preparation of ground coffee	—	25-50 g	P	30 sec.	When filling the chopping cup with coffee beans do not exceed the max mark. Press and hold P button.





Grinding spices	—	5-25 g	P	30 sec.	Cloves, star anise, anise seed, etc. must be grind with other ingredients in order to avoid breakage of the plastic components of the chopper. Press and hold P button.
Preparation of grated cheese	—	25-75 g	P	10 sec.	Recommended for hard cheeses (like Parmesan), before grinding, cheese should be refrigerated. Press and hold P button.
Preparation of powdered sugar	—	25-75 g	P	30 sec.	It is recommended to sift powdered sugar through a fine sieve. Press and hold P button.
Preparation of bread crumbs and biscuit crumbs	—	20-40 g	P	10 sec.	Use impulse mode, press and hold P for 2 sec(10-15 times). To obtain smaller fractions, increase the speed to maximum and grind crumbs for 10 seconds.

PREPARING BABY FOOD

Operation				Note
Puree from hot boiled vegetables	300 g	MAX (5-7)	30 sec.	Recommended for babies up to 18 months, before serving, rub through a sieve.
Puree from boiled meat, fish, poultry.	300 g	MAX (5-7)	60 sec.	Refers to hot products
Preparing baby food from dry baby mixes.	100-200 ml	MIN (1 -3)/ MED(3-5)/ MAX(5-7)	30 sec.	Refers to average servings, depending on the age of the baby. You can maximum prepare 1500 ml of milk. Follow the instructions on the dry baby mix.

CLEANING AND MAINTENANCE

- 1. Add into the cup little detergent and fill with water to 750 ml mark.
- 2. Place the knob to 1 mark.
- 3. After about 1 minute turn off the blender by turning the knob to  place.
- 4. Unplug the device.
- 5. After washing, disassemble the device, wash, and dry the blades. Do not use harsh detergents.
- 6. Wipe the motor unit with a damp cloth. Never immerse it in water because of the danger of electric shock.
- 7. Thoroughly dry all parts.

			
	✓	✓	✓
	✗	✗	✓

NOTE! The blades are very sharp,
be careful.

PRODUCT CERTIFICATION

For information on product certification,
see [http://www.oursson.com/rus/ru/about/
partners/certificates/#tab0](http://www.oursson.com/rus/ru/about/partners/certificates/#tab0) or ask seller for a copy.

SPECIFICATIONS	
MODEL	BL0640G
Power consumption, W	600
Blender jar capacity, ml	2000
Blender jar working capacity, ml	1500
Rated voltage	~ 220-240V; 50 Hz
Protection class	II
Storage and transportation temperature requirements	-25°C to + 35°C
Operation temperature requirements	+5°C to + 35°C
Humidity Requirements	15-75%
Dimensions (HxWxL), mm	218x198x412
Weight, kg	4,24

NOTE! Only a qualified specialist from OURSSON AG service center must do the repair.

SERVICING

Company OURSSONAG expresses great appreciation to you for choosing our products.

We have done everything possible so that this meets your needs, and the quality corresponds to the best world standards. If your OURSSON branded product will need maintenance, please contact one of the authorized service center (hereinafter - ASC). A complete list of ASC and their exact addresses can be found on the website www.oursson.ru, as well as by calling

free hotline number OURSSON AG.

If you have questions or problems with OURSSON AG products, please contact in writing form the organization authorized to accept and meet the demands for the products of poor quality, - «BBK Service Center», 109202, Moscow, Fraser Highway, 17A , 1A or email info@oursson.ru.

Warranty obligations OURSSON AG:

1. Warranty obligations OURSSON AG, provided ASC OURSSON AG, apply only to models designed OURSSON AG for the production or supply and sale within the country where the warranty service is provided, purchased in this country, certified for compliance with the standards of this country, and also marked the with official marks of conformity.
2. Warranty obligations OURSSON AG operate within the law on protection of consumer rights and are regulated by the laws of the country in which they are provided, and only when the product is used exclusively for personal, family or household purposes. Warranty obligations OURSSON AG shall not apply to uses of goods for business purposes or in connection with the acquisition of goods to meet the needs of enterprises, institutions and organizations.

3. OURSSON AG sets for its products the following terms of use and warranty periods:

Product name	Terms of use	Warranty Period
Microwave ovens breadmakers, induction hobs	60	12
Multicookers, kitchen processors, electric kettles, electric grills, hand blenders, hand mixers, meat grinders, blenders, toasters, airpots, toasters, juicers, steamers, coffee makers, choppers	36	12
Kitchen scales	24	12

4. Warranty obligations OURSSON AG shall not apply to the following products, if their replacement is assumed and is not connected with disassembling products:
- Batteries.
 - Cases, straps, cords for carrying, mounting accessories, tools, documentation that came with the product.
5. Warranty does not cover defects caused due to violations of the rules of consumer use, storage or transportation of the goods, actions of third parties or force majeure, including but not limited to the following cases:

- If the defect was a result of careless handling, used for other purposes, violations of conditions and rules of operation set forth in the instruction manual, including as a result of exposure to high or low temperatures, high humidity or dust, traces of opening the device independently and/ or self-repair, mismatch state standards for power grids, getting liquids, insects or other foreign objects, substances inside the device, as well as long-term use of the product in extreme operational modes.
- If the defect of the product was a result of unauthorized attempts to test the product or make any changes in its construction or software programs, including repair or maintenance in unauthorized service centers.
- If the defect of the product was a result of use of non-standard and/or low quality equipment, accessories, spare parts, batteries.
- If the defect of the product is associated with its use in conjunction with additional equipment (accessories), other than additional equipment recommended by OURSSON AG for use with this product.

OURSSON AG is not responsible for the quality of the additional equipment (accessories) manufactured by third parties, for the quality of its products together with such equipment, as well as the quality of the work of the additional equipment of OURSSON AG together with the products of other manufacturers.

6. Product defects detected during the lifetime of the product are eliminated by the authorized service centers (ASC). During the warranty period, elimination of defects is free of charge with the presentation of the original certificate

of guarantee and documents that confirm the fact and date of the contract of retail purchase. In the absence of such documents, warranty period is calculated from the date of manufacture of goods. It should be taken into account:

- Setup and Installation (assembly, the connection, etc.) of the product described in the documentation attached to it, does not enter the scope of warranty OURSSON AG and can be performed by the user as well as the specialists of most authorized service centers on a paid basis.
- Work upon maintenance of products (cleaning and lubricating the moving parts, replacement of consumables and supplies, etc.) are made on a paid basis.

7. OURSSON AG is not responsible for any damage directly or indirectly caused by their products to people, pets, property, if it occurred as a result of non-observance of the rules and conditions of use, storage, transportation or installation of the product, intentional or negligent actions of consumer or third parties.

8. Under no circumstances, OURSSON AG is not responsible for any special, incidental, indirect or consequential loss or damage, including but not limited to: lost profits, damages caused by interruptions in the commercial, industrial or other activities, arising from the use of or inability to use the product.

9. Due to continuous product improvement, design elements and some technical specifications are subject to change without prior notice from the manufacturer.

Using the product when after the terms of use (lifetime):

1. Lifetime set by OURSSON AG for this product applies only when the product is used exclusively for personal, family or household needs, as well as the consumer observes the correct operation, storage and transportation of products. Under the condition of careful handling of the product and compliance with the rules of operation the actual life may exceed the lifetime set by OURSSON AG.
2. At the end of the product lifetime, you should contact an authorized service center for to conduct a preventive maintenance of the product and determine the suitability for further use. Work on conducting a preventive maintenance of the products is also made in service centers on paid basis.
3. OURSSON AG does not recommend the use of this product after the end of its lifetime without its preventive maintenance by the authorized service center, since in this case, the product can be dangerous to the life, health or property of the consumer.

Product Recycling and Disposal

After the expiration of the lifetime, the product cannot be disposed with another household waste. Instead, it shall be deposited in the appropriate recycling collection point for electrical

and electronic equipment for proper treatment and disposal in accordance with federal or local law. By disposing correctly this product, you will help to conserve natural resources and preventing the product from damaging the environment and human health. For more information on the collection point and recycling of this product, please contact your local municipal authorities or the enterprise for household waste disposal.



Date of manufacture

Each product has a unique serial number in the form of alphanumeric row and is duplicated with a barcode that contains the following information: name of the product group, date of manufacture, serial number of the product.

Serial number is located on the rear of the product, on the package and the warranty card.



- ❶ The first two letters-correspondence to the product group (blender - BL).
- ❷ The first two digits – year of manufacture.
- ❸ The second two digits – week of manufacture.
- ❹ The last two digits – serial number of product.

Note! To avoid misunderstandings, we highly recommend you to read carefully the instruction manual and the warranty obligations. Check the correctness of the warranty card. Warranty card is valid only if the following are correctly and clearly stated: model, serial number, date of purchase, clear stamps, buyer's signature. The serial number and the model of the device must be the same as in the warranty card. If these conditions are not fulfilled or the data specified in the warranty card was changed, the warranty card is invalid.



OURSSON AG hotline provides complete information about the company's activity in Russia, CIS and Baltic countries. Professional operators quickly answer to any question. You can contact the unified center for service support, for recommendations about the setup and connection, to get information about local sales, with questions about the promotions and yearly drawings conducted by the company, as well as with any other questions about the company's activities on the territory of Russia, CIS and Baltic countries.

Any questions? Call us, we can help!

Hotline OURSSON AG (free calls from fixed phones)

8 800 100 8708.

The hotline work schedule is: Monday-Friday from 9:00 to 20:00 (Moscow time). Saturday, Sunday and public holidays are rest days.

This manual is under protection of international and Russian copyright law. Any unauthorized use of the instructions, including copying, printing and distribution, but not limited to, involves the application of the guilty person to civil liability and criminal liability in accordance with Article 146 of the Criminal Code and the administrative responsibility in accordance with Article 7.12 of the Administrative Code (previously Article 150.4).

Contact information:

1. Manufacturer of goods - OURSSON AG (Orson AG) Utokvay 39, 8008 Zurich, Switzerland.
2. Organization authorized to accept and meet the demands for the goods of poor quality, – «Management Service Company», 109202, Moscow, Fraser Highway 17A, 1A. Ukraine LLC «Universal Distribution Company», 03065, Kyiv, blvd. I.Lepse / Academica Kablukova, 51/16.
3. Certification information product available on the website www.oursson.com.
4. Importers of products OURSSON AG: Russia: OOO "Orson", 125171, Russia, Moscow, Leningrad Highway 16A, 2. Republica Moldova: S.C. «PLAI VERDE» S.R.L. MD-2002, str. Muncești highway., 271/A, Chișinău. Ukraine: TOV "Universal Distribution Company", 03065, Kyiv, blvd. I.Lepse / Akademika Kablukova, 51/16.
5. Product Suppliers OURSSON AG:
Belarus: "Nikita plus", 220094, Minsk, 2nd Cycle lane., 30, office 603.

OURSSON AG
MADE IN CHINA



www.oursson.com

